

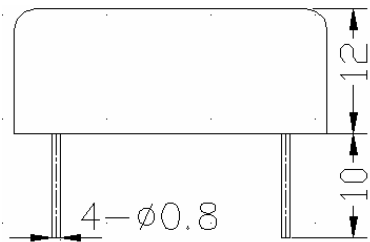

### Specification: Crystal Filter 70MHz

### Part Number: 70M68C50

| Item                                      | Typical   |
|---|-----------|
| Nominal Frequency ( MHz, fo )             | 70        |
| Insertion Loss ( dB )                     | ≤5.0      |
| Ripple Within Pass Band ( dB, fo±15 kHz ) | ≤1.3      |
| Bandwidth at 6 dB Attenuation ( kHz )     | ≥±34      |
| Bandwidth at 60 dB Attenuation ( kHz )    | ≤±91.8    |
| Group Delay ( us, fo±23kHz )              | ≤5        |
| Ultimate Rejection ( dB )                 | 60        |
| I/O Impedance ( Ω )                       | 50        |
| I/O VSWR                                  | ≤2.0      |
| Operation Temperature ( °C )              | -55 ~ +75 |
| Storage Temperature ( °C )                | -55 ~ +85 |
| Package Size ( mm )                       | 30x20x12  |



| Pin No. | Description  |
|---------|--------------|
| 1       | Input/Output |
| 2       | Output/Input |
| 3,4     | Ground       |

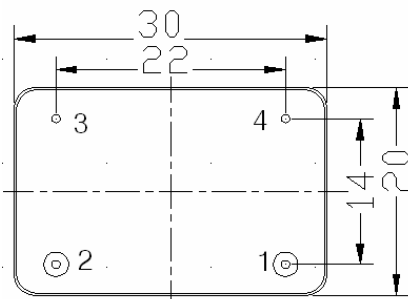

Bottom View

Unit:mm